

RB1200HC
Back Plate with Belt



Belt 280-0012

RB800, RB1200HC, RB2400

CENTRIFUGAL BLOWER BELT MAINTENANCE



REPUBLIC NOTES

WARNING

Service procedures should only be performed by trained service personnel.

IMPORTANT

Disconnect blower from electrical source before attempting service.

CONTENTS

Warning and Important Note.....	2
Belt Removal & Installation.....	4-6
Spring Replacement Intsallation.....	7



BELT REMOVAL AND INSTALLATION

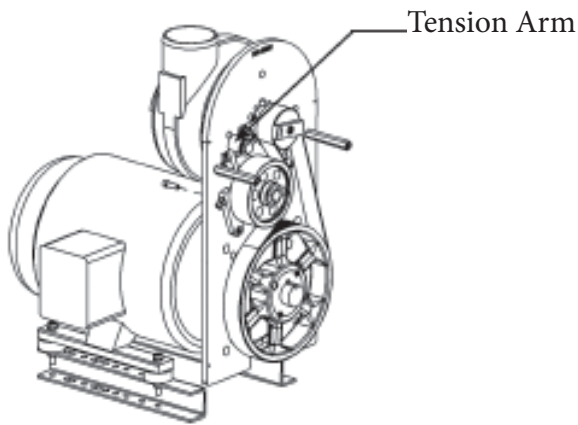

In order to remove or replace the Belt, the Tension Block Assembly must be rotated out of the way to allow for the Tension Arm to swing (CW). Loosen the 5/16-18 SHCS as shown in Figure 1, the screw is located on the backside of the Mounting Plate. Use a 1/4" allen wrench (not shown) on the 5/16-18 SHCS.

FIGURE 1

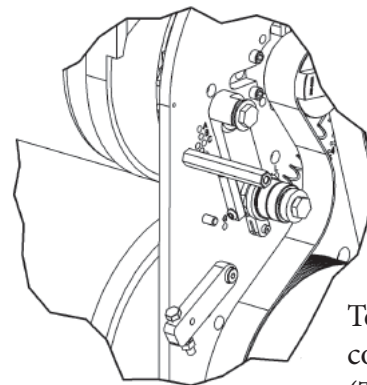
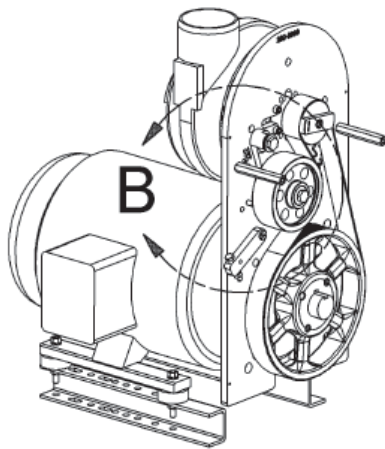

Tension Block rotated
counterclockwise (CCW)
(Tension Pulley removed
for clarity)

DETAIL B

FIGURE 2

Once the 5/16-18 SHCS is removed, rotate the Tension Block (CCW) to allow for the Tension Arm to swing (CW) as shown in Detail B.

NOTE:

The same belt removal and installation procedure applies for the RB2400 model with one exception– there are two (2) belts.

BELT REMOVAL AND INSTALLATION

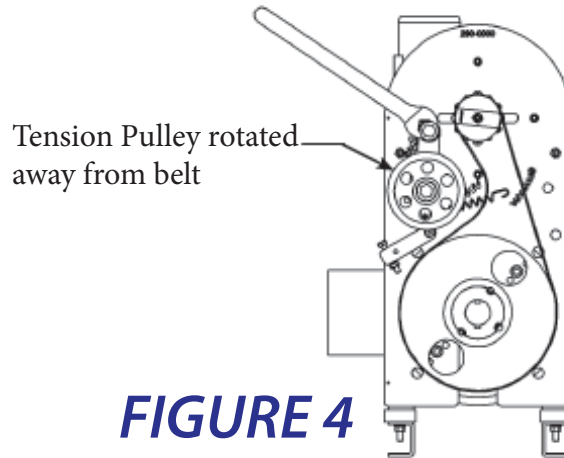
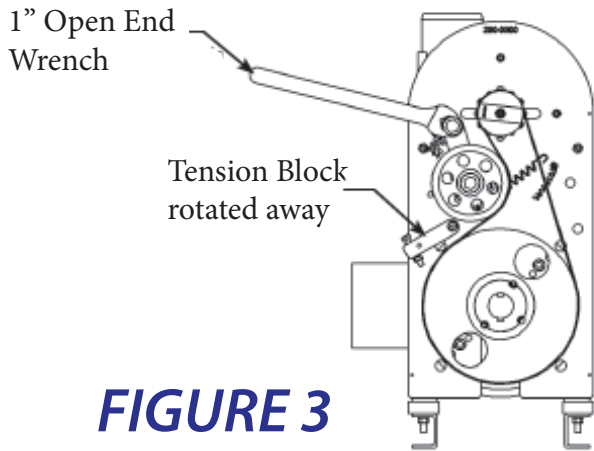

Using a 1" open-end wrench, as shown in Figures 3 and 4, rotate the Tension Arm Assembly clockwise (CW) and remove the Belt. You may release the pressure on the wrench and allow the Tension Arm to swing back into position once the Belt has been removed.

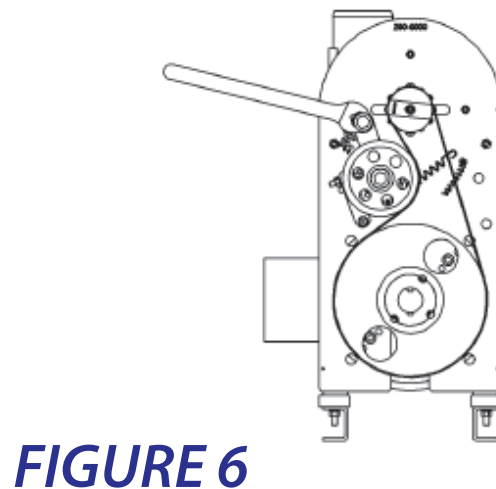
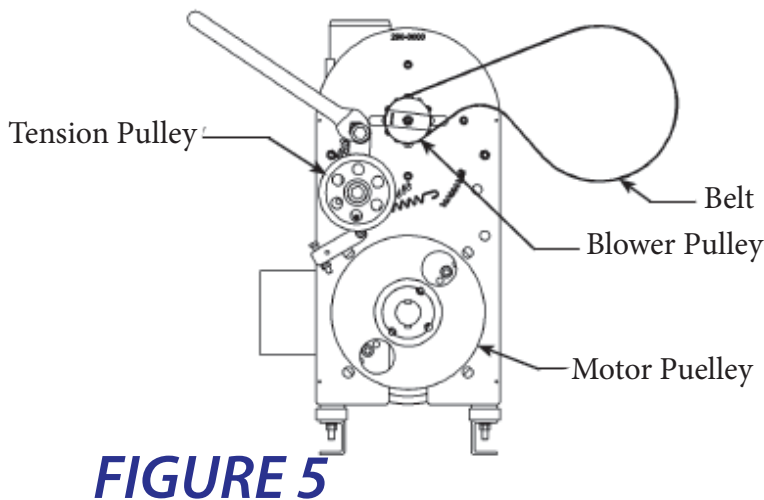

Using a 1" open-end wrench, rotate the Tension Arm Assembly clockwise (CW). Wrap the new or replacement Belt around the Blower Pulley and then onto the Motor Pulley as shown in Figures 5 and 6. Once the Belt is in place and the wrench is removed, verify that the Belt is seated into all the grooves on both pulleys by manually rotating the Motor Pulley (large pulley), and checking the alignment of the Belt on the grooves.

NOTE:

The same belt removal and installation procedure applies for the RB2400 Model with one exception- there are two (2) belts.



BELT REMOVAL AND INSTALLATION

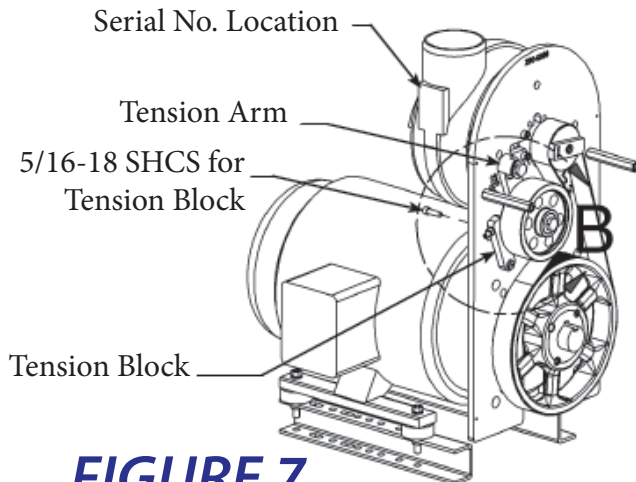

FIGURE 7

Rotate the Tension Block (CW) back into position and reinstall 5/16-18 SHCS through the back side of the Mounting Plate using a 1/4" allen wrench.

NOTE:

The Tension Block is not to be used for tensioning the belt. The purpose of the Tension Block is to help control the Tension Arm “backlash” on motors with high starting torque.

Using a flat blade screwdriver, adjust the slotted 5/16-18 SS Hex Head screw on the Tension Block until the Hex Head just touches the Rubber Block on the Tension Arm assembly. Tighten jam nut with a 1/4" wrench and reinstall the belt guard cover.

DETAIL B

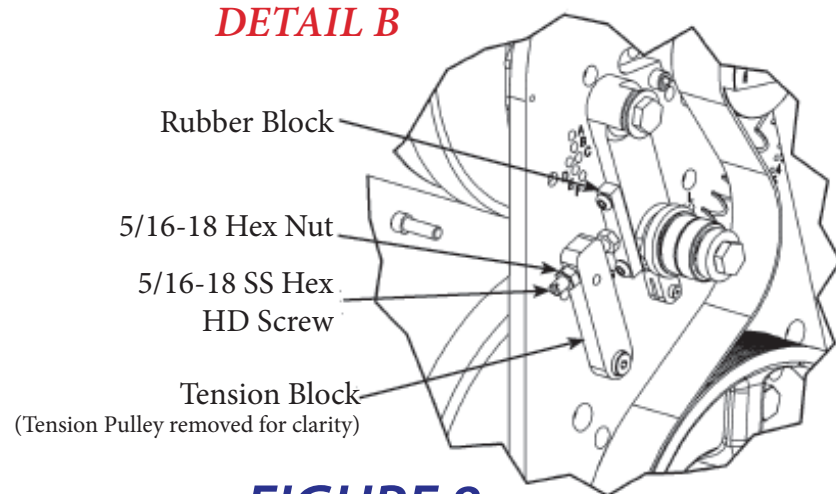

FIGURE 8

NOTES:

The hex head screw is not designed to put additional pressure on the Tension Arm or Belt, it is intended to prevent the backward movement of high torque motors.

The same belt removal and installation procedure applies for the RB2400 Model with one exception– there are two (2) belts.

SPRING REPLACEMENT INSTALLATION

Important–Replace spring when replacing belt to insure proper tension on you new belt.

1. Remove spring from 1/4 shoulder bolt on blower mounting plate.
2. Remove the tension pulley assembly from mounting plate by removing pivot pin (Item 11).
3. Remove the tension pulley shaft (Item 3). THis shaft has left-handed threads, so you will need to turn clockwise to loosen. Items 4, 5, 6, 13, and 14 will remain attached to Item 3.
4. Remove shoulder bolt (Item 12).
5. Replace spring and reinstall shoulder bolt (Item 12).
6. Reinstall tension pulley assembly to mounting plate by tightening pivot pin (Item 11). Use Loctite 242 (removable strength) and torque to 25 ft/lbs.
7. Apply Loctite 242 (removable strength) to tension pulley shaft threads (Item 3) and install to tension arm (Item 2). Twist tension pulley shaft counterclockwise to tighten.
8. Reinstall spring to 1/4 shoulder bolt on blower back plate.

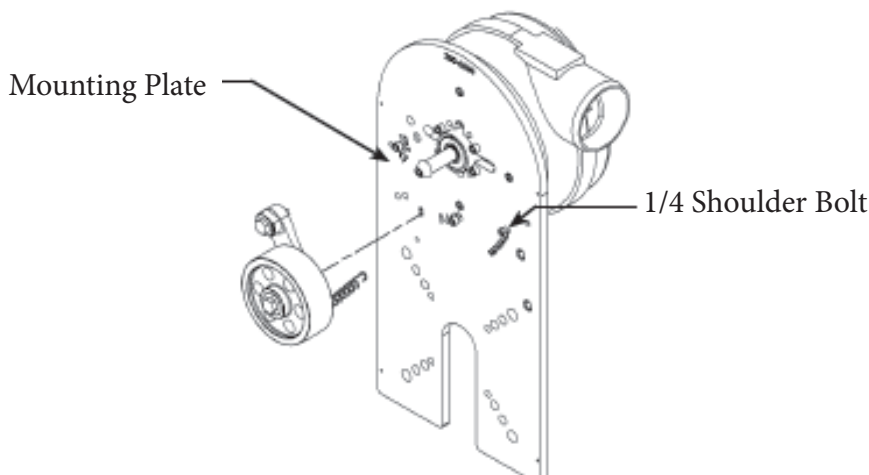

Item No.	Part No.	Qty.	Description
1	210-0701	1	Spring Ext. .080 Tension Pulley
2	290-0107	1	Tension Arm
3	250-0406	1	Bearing 6301-2RS
4	250-0701	2	Shaft TP Double Brg.
5	230-0707	1	5" Double Bearing Tension Pulley
6	210-0502	1	Retaining Ring N5000-145
7	290-0201	1	Rubber Block
8	210-1504	2	Screw, SS 1/4-20 x 5/8 Button Soc. Hd.
9	250-0703	2	Flanged Nylon Bearing 10L7-F
10	210-0310	1	Washer, SS 1-3/16 x 5/16 x .058
11	250-0402	1	Pivot Pin Tension Pulley
12	210-0603	1	Shoulder Bolt, SS 3/16 x 5/16
13	250-1007	1	Seal TP CR6767
14	250-1008	1	Seal CR13514

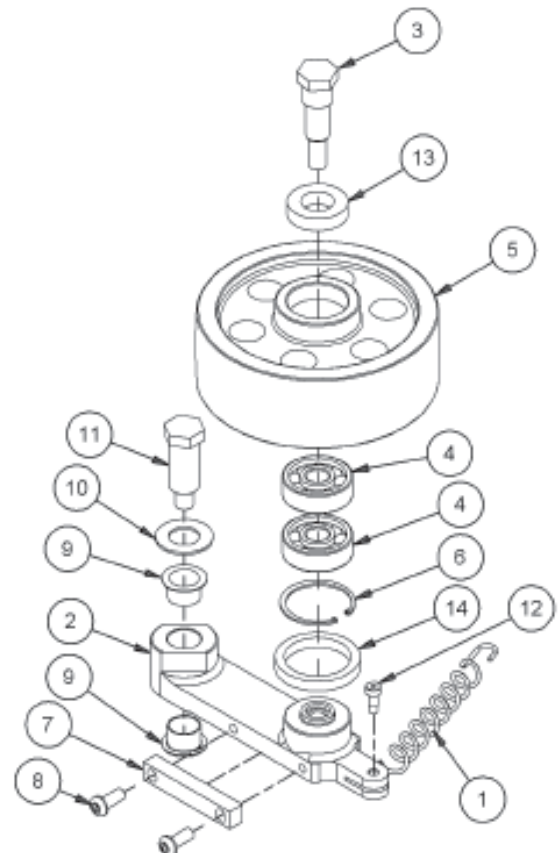

NOTES:

Spring replacement procedure is the same for both the 4" and 5" Tension Pulley Assemblies.



5131 Cash Road Dallas, TX 75247

800.847.0380

www.republic-mfg.com

