

Maintenance Kits and Parts List for the RXA-630

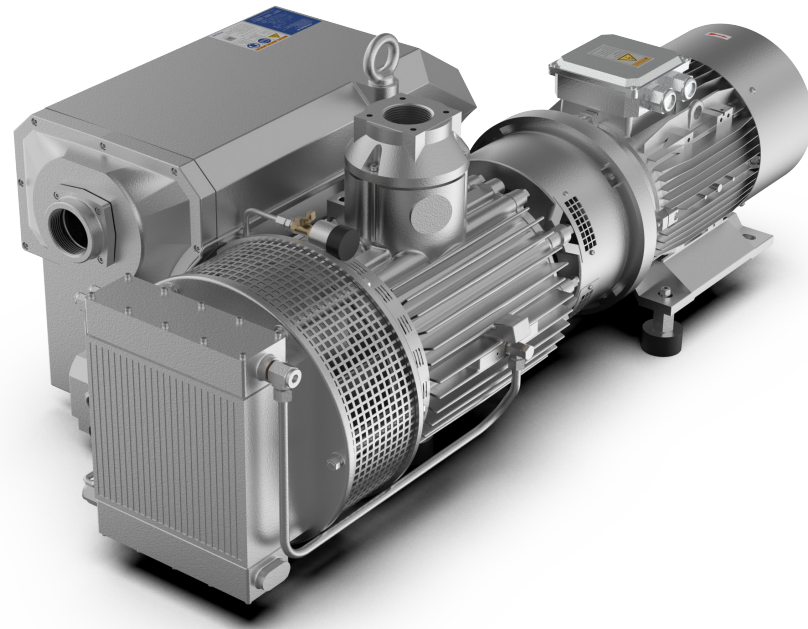

RXA-630
OIL LUBRICATED VACUUM PUMP
Part Numbers cover all revisions and motor configuration of RXA-630

RXA-630

OIL LUBRICATED VACUUM PUMP

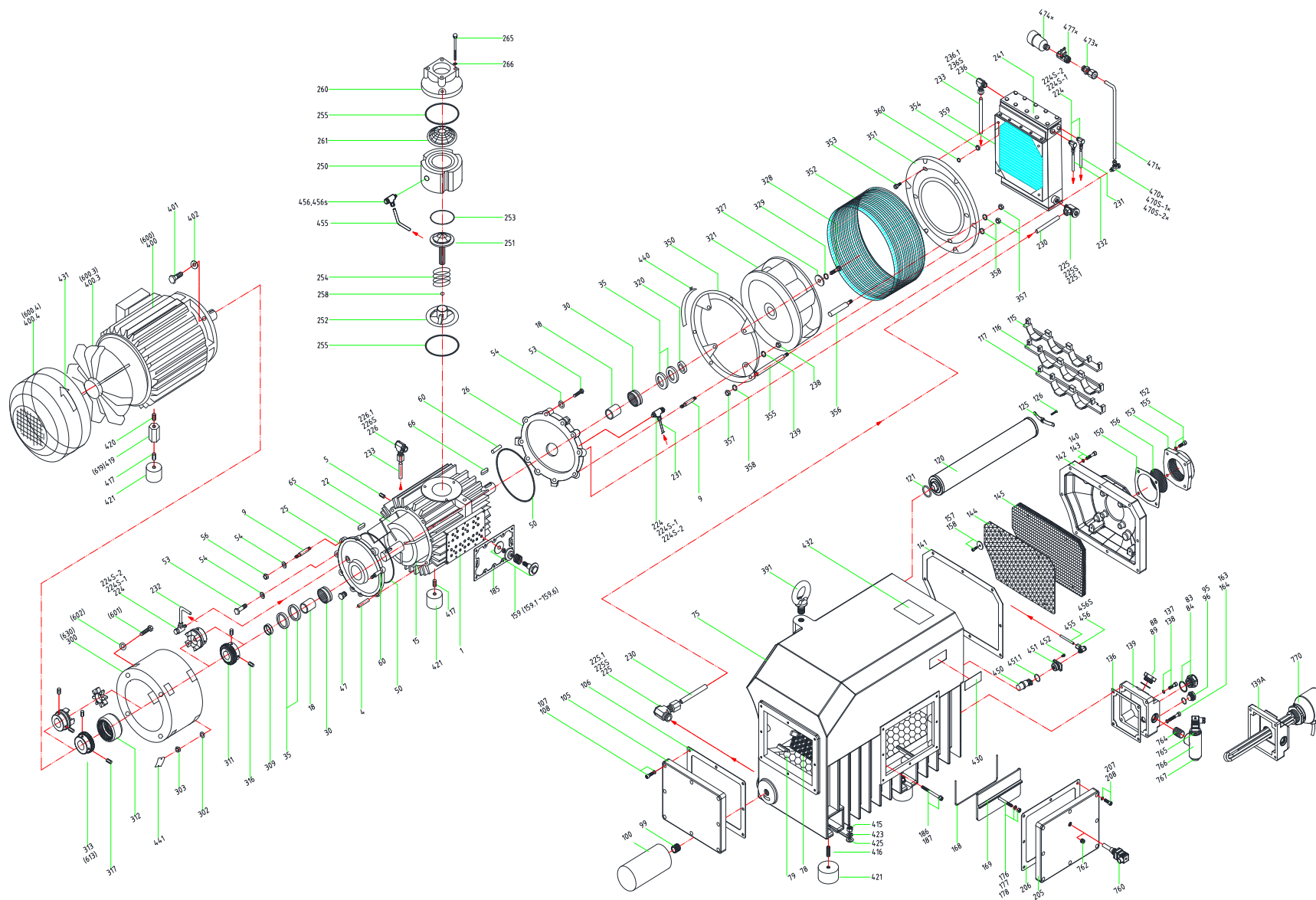

1.800.847.0380
5131 Cash Road Dallas, TX 75247 USA

info@republic-mfg.com
www.republic-mfg.com

PARTS LIST

Pos. No.	Part No.	Description	Qty	Notes
490	1200.490.01	Gasket Kit, RXA-630		
500	1200.500.02	Rebuild Kit, RXA-630		KITS
501	1200.501.01	Filter Kit, RXA-630		
1	1200.001.A0	Cylinder257x400, pcd300x16, RXA-630	1	
4	1200.004.00	StudM16x87, RXA-402/500/630	4	
5	0000.C6B.00	Set screw (Pump side)M8x10, RXA-12/21/402/500/630	6	
9	1200.009.00	StudM16x76, RXA-402/500/630	6	
15	1200.015.00	Rotors214x400, RXA-630	1	
18	1200.018.A0	Sleeve, Bearing IR e45xe52x62 (1pc) RXA-402/500/630	2	Included in Rebuild Kit
18-19		Sleeve, Bearing	2	
22	1200.022.B0	Vane400 x 72 x 5.85,carbon, RXA-630	3	Included in Rebuild Kit
25	1200.025.00	A-End plate, Motor side, RXA-402/630	1	
26	1200.026.00	B-End plate, Fan Side, RXA-402/630	1	
30	0000.G05.00	Bearing RNA6909 , RXA-402/500/630	2	Included in Rebuild Kit
35	0000.U5E.00	Shaft seal, vitoneS2xe88x9, RXA-402/500/630	4	Included in Rebuild Kit
47	0000.OBA.00	Plug for Gas BallastG14", RXA-402/500/630	1	
50	0000.U23.00	O-ring, End plate e265x4.0, RXA-402/500/630	2	Included in Rebuild Kit
53	0000ADL.00	Hexagon head cap screwM16x50, RXA-402/500/630	10	
54	0000.F21.00	Spring Lock WasherSW, e16, RXA-402/500/630	12	
56	0000.F11.00	Hex nutM16, RXA-402/500/630	2	
60	0000.4MY.00	Taper Pin e8x60, RXA-402/500/630	4	Included in Rebuild Kit
65	0000.8KM.00	A-Shaft key, Motor Side14x9x45, RXA-402/500/630	1	
66	0000.8KM.00	A-Shaft key, Motor Side14x9x45, RXA-402/500/630	1	
75	1200.075.B0	Oil sump, RXA-630	1	
78	1200.078.A0	Steel demisterS-STL, RXA-402/500/630	1	
79	1200.079.A0	Sheet metal baffle560x200, RXA-402/500/630	1	
83	0000.OSG.00	Oil sight glass (option)G1", RXA-16	1	
84	0000.U7B.00	Gasket, Oil sight glass	1	Included in Rebuild Kit
88	0000.OWG.A0	Plug, Oil fill G 1", RXA-402/630	1	
89	0000.URX.00	O-Ring, Oil fill plug e34x40x11, RXA-630	1	Included in Rebuild Kit
90	00GA.090.00	Pressure gage01 Bar, RXA-12/16/21	1	
95	0000.OTE.00	Plug, Oil Drain G 1/2" Plastic, RXA-16	1	
96	0000.U04.00	O-Ring, Oil drain plug e22 x T2.0, RXA-16	1	Included in Rebuild Kit
99	1200.099.00	Pipe Nipple1" - 12 UNF, RXA-402/500/630	1	
100	1200.100.00	Oil filter, RXA-402/500/630	1	Included in Rebuild Kit
105	1200.105.00	Oil sump cover plate300x240x15/8-e9, RXA-500/630	1	
106	1200.106.00	Gasket, Oil sump cover 300x240x11, RXA-500/630	1	Included in Rebuild Kit
107	0000.B8G.00	Allen bolt	8	
108	00HF.104.00	Sealing ring	8	
115	1200.115.00	Exh. Filter bracket, UpperFor 3 filter elements, RXA-402/500/630	1	
116	1200.116.00	Exh. Filter bracket, MediumFor 3 filter elements, RXA-402/500/630	1	
117	1200.117.00	Exh. Filter bracket, LowerFor 2 filter elements, RXA-402/500/630	1	
120	1200.120.A0	Exhaust filtere70 x 500, RXA-402/500/630	8	Included in Rebuild Kit
121	0000.U08.00	O-ring, Exhaust filtere35x4.0, RXA-12/16/21	8	Included in Rebuild Kit
125	0020.125.00	Exh. Filter spring Assembly106x12x1.5 / M4, RXA-12/16/21	8	
126	0000.E3F.00	Slotted cheese head machine screw	8	
136	1200.136.00	Gasket, Service cover 159x154x1/4-e9, RXA-402/500/630	1	Included in Rebuild Kit

Pos. No.	Part No.	Description	Qty	Notes
137	00HF.104.00	Sealing ring	2	
138	0000.B8H.00	Allen bolt	2	
139	1200.139.B0	Service cover for level Sw and heater 159x154x60/4-e9, RXA-402/500/630	1	
139	1200.139.A0	Service cover for level Sw 159x154x60/4-e9, 3/4" PS Tap, RXA-402/500/630	1	
139	1200.139.00	Service cover159x154x60/4-e9, RXA-402/500/630	1	
140	0000.B8J.00	Allen boltM8x40, RXA-402/500/630	8	
141	1200.141.A0	Gasket, Separator cover 420x275x11, RXA-402/500/630	1	Included in Rebuild Kit
142	1200.142.A0	Separator cover plate 420x275/8-e9, RXA-402/500/630	1	
143	00HF.104.00	Sealing ring	8	
144	1200.144.A0	Perforated metal screen Wire Mesh, RXA-402/500/630	2	
145	1200.145.A0	Strainer, baffleNon Woven, RXA-402/500/630	1	Included in Filter Kit
150	1200.150.00	Gasket, Exhaust cover 125x125x11, RXA-402/500/630	1	Included in Rebuild Kit
152	00HF.104.00	Sealing ring	4	
153	1200.153.00	Exhaust Cover (threaded)125x125/4-e9, RXA-402/500/630	1	
155	000.B8G.00	Allen Bolt (Socket Head Cap Screw)M8 x 25, RXA-402/500/630	4	
156	1200.156.00	Outlet screene95x11, RXA-402/500/630	1	
157	0000.B6E.00	Allen boltM6x15, RXA-402/500/630	4	
158	1200.158.00	WasherPW e6.5xe30 2t, RXA-402/500/630	4	
159	0500.159.00	Exhaust valve ass'y (159.1 - 159.6), RXA-250/302/402/500/630	7	
159.1	0500.159.01	Exhaust valve fixed boltM8, RXA-250/302/402/500/630	7	
159.2	0500.159.02	Exhaust valve washere32xe12.5x21, RXA-250/302/402/500/630	7	
159.3	0500.159.03	Exhaust valve spring, RXA-250/302/402/500/630	7	
159.4	0500.159.04	Exhaust valve platee53xe9.3x3.6, RXA-250/302/402/500/630	7	
159.5	0500.159.05	Exhaust valve lock nute18xM8x5.5t, RXA-250/302/402/500/630	7	
159.6	0500.159.06	Exhaust valve seat platee54xe10x4t, RXA-250/302/402/500/630	7	Included in Gasket Kit
159	0500.159.A0	Exhaust valve ass'y (159.1 - 159.6)	7	
159-1	0350.159.A1	Exhaust valve fixed bolt, Exhaust valve washer	7	
159-3	0000.V12.00	Exhaust valve spring	7	
159-4	0350.159.04	Exhaust valve plate	7	
159-5	0350.159.A5	Exhaust valve lock nut	7	Included in Rebuild Kit
159-6	0350.159.A6	Exhaust valve seat plate	7	Included in Rebuild Kit
163	000.B8L.00	Allen boltM8x50, RXA-402/500/630	2	
164	00HF.104.00	Sealing ring	2	
168	1200.168.00	O-Ring, Exh. Valve cover platee3 x L420, RXA-402/500/630	1	Included in Rebuild Kit
169	1200.169.00	Exh. Valve cover plate110x225, RXA-402/500/630	1	
176	0000.F2E.00	Spring lock washer	1	
177	0000.D8X.00	Stud boltM8x110, RXA-402/500/630	1	
178	0000.F2E.00	Spring lock washer	1	
185	1200.185.A0	Gasket, Cylinder 260x185x1/12-e9, RXA-402/500/630	1	Included in Rebuild Kit
186	0000.B8V.00	Allen boltM8x95, RXA-402/500/630	12	
187	0000.F2E.00	Spring lock washer	12	
205	1200.205.A0	Oil Sump Side cover plate300x240x15/8-e9, 1/2" Tap, RXA-402/500/630	1	
205	1200.205.00	Oil sump cover plate300x240x15/8-e9, RXA-402/500/630	1	
206	1200.206.00	Gasket, Oil sump cover 300x240x11, RXA-402/500/630	1	Included in Rebuild Kit
207	0000.B8G.00	Allen bolt	9	
208	00HF.104.00	Sealing ring	8	
224	00HF.020.00	BSLM, Hydraulic fittingBSLM,G1/4" x e10, RXA-402/500/630	4	



1.800.847.0380

5131 Cash Road Dallas, TX 75247 USA

info@republic-mfg.com

www.republic-mfg.com

PARTS LIST(cont.)

Pos. No.	Part No.	Description	Qty	Notes
224S-1	00HF.109.00	Sealing Ring for 221	4	Included in Rebuild Kit
224S-2	00HF.108.00	Sealing Ring for 221	4	Included in Rebuild Kit
224.1	1200.224.01	Compression Ring10mm, RXA-402/500/630	4	
225	00HF.022.00	BSLM Hydraulic fittingBSLM.M26 x e22, RXA-402/500/630	2	
225S	1200.225.00	Sealing Ring for 225a26xe34x21, RXA-630	2	Included in Rebuild Kit
225.1	1200.225.01	Compression Ring22mm, RXA-402/500/630	2	
226S	00HF.113.00	Sealing Ring	2	Included in Rebuild Kit
226	00HF.017.00	BSLM Hydraulic fittingBSLM 18 x e 15, RXA-165/202/250/302/630	1	
226.1	1200.226.01	Compression Ring15mm, RXA-402/630	2	
230	1200.230.80	Oil tube (A)e22x1.5 x 950, RXA-630	1	
230	1200.230.A0	Oil tube (A)e22x1.5 x 895 for 120241A, RXA-630	1	
230	1200.230.00	Oil tube (A)e22x1.5 x 880 for 120241, RXA-630	1	
231	1200.231.A0	Oil tube (B-1)e10 x 1 x 1145 for 120241A, RXA-630	1	
231	1200.231.00	Oil tube (B-1)e10 x 1 x 1045 for 120241, RXA-630	1	
232	1200.232.A0	Oil Tube (B-2)e10 x 1 x 1523 for 120241A, RXA-630	1	
232	1200.232.00	Oil Tube (B-2)e10 x 1 x 1523 for 120241, RXA-630	1	
233	1200.233.A0	Oil Tubee15 x1.5 x 1008 for 120241A, RXA-630	1	
233	1200.233.00	Oil Tubee15 x1.5 x 990 for 120241, RXA-630	1	
236	00HF.019.00	BSLM Hydraulic fittingBSLM, G1/2" x e15, RXA-402/500/630	1	
236S	00HF.111.00	Sealing Ringe18xe29x21, RXA-402/500/630	1	
236.1	1200.236.01	Compression Ring15mm, RXA-402/500/630	1	
238	0000.F11.00	Hex nutM16, RXA-402/500/630	4	
239	0000.F21.00	Spring Lock WasherS/W, e16, RXA-402/500/630	4	
241	1200.241.A0	Oil Cooler (Top& bottom opening), RXA-402/500/630	1	
241.1	1200.241.A1	gasket, Oil Cooler, RXA-402/500/630	2	
241	1200.241.C0	Oil Cooler (STD), RXA-402/500/630	1	
250	1200.250.00	Inlet flange, Lower housing, RXA-402/500/630	1	
251	1200.251.00	Check valve plate, RXA-402/500/630	1	
252	1200.252.00	Check valve guide, RXA-402/500/630	1	
253	0000.U15.00	O-Ring, Check valve plate e97x 5.0, RXA-402/500/630	1	Included in Rebuild Kit
254	1200.254.A0	Spring, Check valve, RXA-402/500/630	1	
255	0000.U19.00	O-Ring, Inlet Flangee140 x 5.0, RXA-402/500/630	2	Included in Rebuild Kit
258	1200.258.00	Rubber Ball12.7, RXA-402/500/630	1	Included in Rebuild Kit
260	1200.260.00	Inlet flange, Upper HousingG 3", RXA-402/500/630	1	
261	1200.261.00	Inlet screen (Conical), RXA-402/500/630	1	Included in Rebuild Kit
261	1200.261.A0	Inlet screen (Conical), RXA-402/500/630	1	
265	0000.B82.00	Allen boltM8x140, RXA-402/500/630	3	
266	0000.F2E.00	Spring lock washer	3	
300	1200.300.00	Motor mounting brackets350x230/pcd30xM16-4, RXA-402/500/630	1	
302	0000.F21.00	Spring Lock WasherS/W, e16, RXA-402/500/630	4	
303	0000.F11.00	Hex nutM16, RXA-402/500/630	4	
309	1200.309.00	Spacer for Coupling Half, Pump Sidee59xe45.2x151, RXA-402/500/630	1	
310	1200.310.00	Coupling set (311-313)/Coupling set, RXA-630	1	
311	0800.FCP.00	Coupling Half, Pump SideFlange type, RXA-402/500/630	1	
312	0800.FCB.00	Connection Bolt with rubber bootBolt + washer + Rubber + Nut, RXA-402/500/630	8	Included in Rebuild Kit
312.1	1200.312.01	BoltM20x80, RXA-402/500/630	8	
312.2	1200.312.02	WasherP/W e23.5xe32x41, RXA-402/500/630	8	

Pos. No.	Part No.	Description	Qty	Notes
312.3	1200.312.03	Rubber BootRubber, RXA-402/500/630	8	
312.4	1200.312.02	WasherP/W e23.5xe32x41, RXA-402/500/630	8	
312.5	0000.F2K.00	Spring Lock WasherS/W M20, RXA-402/500/630	8	
312.6	0000.F1K.00	Hex nutM20, RXA-402/500/630	8	
313	1200.FCM.00	Coupling Half, Motor Side(IEC)Flange type, IEC, # 200(e55V #180(e48), RXA-630	1	
310 (new)	1200.310.A0	Coupling set (311-313), RXA-630	1	
311	0800.TCP.00	Coupling Half, Pump SideTeeth type, e45mm, RXA-402/500/630	1	
312	0800.TCS.00	Coupling, SleevePlovamid with carbon fiber share,natural rubber, RXA-402/500/630	1	
313	1200.TCM.00	Coupling Half, Motor Side (IEC)Teeth type, e55mm IEC 200, RXA-630	1	
313	0800.TCM.A0	Coupling Half, Motor Side (IEC)Teeth type, e48mm IEC 180, RXA-402/500/630	1	
310 jaw type	0800.TCP.00	Coupling Half, Pump SideTeeth type, e45mm, RXA-402/500/630	1	
310	0800.TCP.00	Coupling Half, Pump SideTeeth type, e45mm, RXA-402/500/630	1	
311	0800.JCP.00	Coupling Half, Pump SideJaw type, e45mm, RXA-402/500/630	1	
312	0800.JCI.00	Coupling, SleeveSpider type, Sleeve, RXA-402/500/630	1	
313	1200.JCM.00	Coupling Half, Motor Side (IEC)Jaw type, e55mm IEC 200, RXA-630	1	
313	0800.JCM.A0	Coupling Half, Motor Side (IEC)Jaw type, e48mm IEC 180, RXA-402/500/630	1	
316	0000.C8C.00	Set screw (pump side)	2	
317	0000.C8C.00	Set screw (pump side)	2	
320	1200.320.00	Spacer for fan e 55 xe45.1 x 10, RXA-402/500/630	1	
321	1200.321.00	Fane 380 x 180 x e45, RXA-402/500/630	1	
327	1200.327.00	Locking Discce60 x e8.5 x 8, RXA-402/500/630	1	
328	0000.B8G.00	Allen bolt	1	
329	0000.F2E.00	Spring lock washer	1	
350	1200.350.00	Fan Support Ring (Pump Side)e480, RXA-402/500/630	1	
351	1200.351.00	Fan Support Ring (Radiator Side)e480x260x171, RXA-402/500/630	1	
352	1200.352.00	Fan Guarde460x170x1.61, RXA-402/500/630	1	
353	0000.B8G.00	Allen bolt	4	
354	0000.F2E.00	Spring lock washer	4	
355	1200.355.00	Fan Supporting BoltM12X235, RXA-402/500/630	5	
356	1200.356.00	Fan Supporting BoltM12X140, RXA-402/500/630	1	
357	0000.F1G.00	Hex nut	11	
358	0000.F2G.00	Spring Lock Washer	11	
359	1200.359.A0	Mounting Bracket for radiatorFor STD radiator, PN 120241C, RXA-402/500/630	1	
359	1200.359.A0	Mounting Bracket for radiatorFor STD radiator, PN 120241C, RXA-402/500/630	1	
359	1200.359.B0	Mounting Bracket for radiator, RXA-630	1	
360	1200.360.00	Cheese head Cap ScrewM5 x 10, RXA-402/500/630	12	
391	0000.F5M.00	Eye boltM24, RXA-402/500/630	1	
400		Motor (IEC)	1	
400		Motor (IEC)	1	
400.3	1200.400.03	Motor fan blade, RXA-402/500/630	1	
400.4	1200.400.04	Motor fan cover, RXA-402/500/630	1	
401	0000.ADJ.00	Hexagon head screwM16x40, RXA-402/500/630	4	
402	0000.F21.00	Spring Lock WasherS/W, e16, RXA-402/500/630	4	
415	0000.F1G.00	Hex nut	2	
416	0000.CBJ.00	Slotted set screwM12x40, RXA-402/500/630	2	
417	0000.CBH.00	Slotted set screwM12x30, RXA-402/500/630	2	
419	1200.419.00	Spacer for Foot, for IEC motorFor IEC Motor, RXA-630	1	



1.800.847.0380

5131 Cash Road Dallas, TX 75247 USA

info@republic-mfg.com

www.republic-mfg.com

PARTS LIST(cont.)

Pos. No.	Part No.	Description	Qty	Notes
420	0000.CBJ.00	Slotted set screwM12x40, RXA-402/500/630	1	
421	0000.F8G.00	Rubber foote75 x 45 x M12, RXA-402/500/630	4	
423	0000.F2G.00	Spring Lock Washer	2	
425	1200.425.00	Washers12 x e30x3.5, RXA-402/500/630	2	
430	1111.001.00	Name plateAL, 85 x 38 x 10.4, RXA-12/16/21	1	
431	1111.003.00	Directional arrow label 15x40, RXA-16	1	
432	1111.006.00	Label, maintenance	1	
440	1200.440.00	Guard, for Fan, RXA-402/500/630	1	
441	1200.441.00	Guard, for Coupling in mounting Bracket, RXA-402/500/630	3	
449	0320.449.00	Float Assembly		
449	0320.449.A0	Float Assembly		
450	0060.450.00	Float - With Rubber Pad, Pin, Orifice & O-ring, RXA-16	1	
451	0500.451.00	Nozzle Assembly 1/8", with O-ring, RXA-175/402/500/630	1	
451.1	0000.U06.00	O-Ring, Check valve platee24 x T2.0, RXA-16	1	Included in Rebuild Kit
452	0000.E11.00	Bolt	2	
455	1200.455.00	Oil Return tube Seamless Tube e6x920, RXA-630	1	
456	1200.291.00	Hyd. fitting BSLM, 1/8 x e6, RXA-630	2	
456S	00HF.105.00	Sealing Ringe10xe14x11, RXA-12/16/21	4	Included in Rebuild Kit
470*	00HF.014.00	BSLM hydraulic fitting	1	
470S*-1	00HF.108.00	Sealing Ring for 221	1	Included in Rebuild Kit
470S*-2	00HF.109.00	Sealing Ring for 221	1	Included in Rebuild Kit
471*	1200.471.00	Oil tube(C)e10, RXA-402/500/630	1	
473*	00HF.023.00	Fitting	1	
474*	1200.474.00	Gas Ballast G3/8"x e50 x 65, RXA-402/500/630	1	
474*-1	1200.474.01	Foam Filter Element, Gas Ballast, RXA-402/630	1	
477*	0000.SCA.00	Bail Valve	1	
480*	1200.480.00	Gas Ballast KitPos # 470 thru 477, RXA-402/500/630	1	
541	1200.541.A0	Conversion Kit, F type (w/o GB Kit) 0.5mbar F-vlv sys w/o GB Kit, RXA-402/500/630	1	
550	1200.550.00	Inlet Check Valve Kit (250 -266), RXA-402/500/630	1	
560	1200.560.00	Aqua version kitHeater, level switch and Service cover, RXA-630	1	
600		Motor (NEMA) - 60Hz	1	
600.3	1200.600.03	Motor fan blade, RXA-630	1	
600.4	1200.600.04	Motor fan cover, RXA-630	1	
601	0000.BRM.00	Allen Bolt5/8"x55, RXA-402/500/630	4	
602	1200.602.00	Spring Lock WasherSW, e 5/8", RXA-630	4	
612	0800.612.00	Coupling set (311 + 312+ 613), NEMA MotorFor Nema, RXA-402/500/630	1	
613	1200.FCM.A0	Coupling Half, Motor Side (NEMA)Flange type, NEMA Motor e 2.125"(63.96), RXA-630	1	
612 (new)	0800.612.A0	Coupling set (311+312+613), RXA-402/500/630	1	
613	1200.TCM.A0	Coupling, Motor side(NEMA)Teeth type, e53.975mm 324TC, RXA-630	1	
612 Jaw type	0800.612.B0	Coupling set (311+312+613), RXA-402/500/630	1	
613	1200.JCM.A0	Coupling, Motor side(NEMA)Jaw type, e53.975mm 324TC, RXA-630	1	
619	1200.619.00	Spacer for foot, for Nema MotorHex Bar, 38 x 61 x M12, RXA-630	2	
630	1200.630.00	Motor mounting bracket, RXA-630	1	
760	1200.760.00	Oil Temperature SwitchBimetal, Brass, 1/2" threads, 120°C w/connector, RXA-402/500/630	1	
762	0000.OTE.00	Plug, Oil Drain G 1/2" Plastic, RXA-16	1	
765	1200.765.00	Oil Level SwitchFloat type, SUS, N.O. w/housing, RXA-165/202/402/500/630	1	

Pos. No.	Part No.	Description	Qty	Notes
765	0060.765.A0	Oil Level Switch	1	
770	00HK.400.00	Heater with controlKw, PT-2", RXA-402/500/630	1	
770	00HK.300.00	Heater with controlKw, PT1-1/2" x470 x300, RXA-402/500/630	1	
770	00HK.200.00	Heater with controlKw, PT1-1/2" x470 x300, RXA-402/500/630	1	
	00IF.006.00	G3", Stil Canister(IF 270), RXA-630	1	
771	0WCK.771.00	Water Cooler kitBar plate type cooler, hoses, adapter, fittings and Valve, RXA-402/500/630		
790	1200.790.00	Water Separator, Automatic1510mm x e 490mm, SUS 304, RXA-402/500/630	1	
791	1200.791.00	Exhaust Separatorwater/oil separator / Exhaust oil Catchpot, RXA-630		
792	1200.792.00	Three Way Valve	1	
800	00IF.007.00	Inlet Air FilterG 3", Al. Alloy Casting(IF 350), RXA-402/500/630	1	
810	1200.810.00	Base, RXA-402/500/630		
900	1200.900.00	Pump Modulemodule, RXA-630	1	



1.800.847.0380

5131 Cash Road Dallas, TX 75247 USA

info@republic-mfg.com

www.republic-mfg.com